

**SAMSUNG
ELECTRONICS**



2013/10 Rev.1.0



Bluetooth speaker

User manual

www.samsung.com

Copyright

Copyright © 2013 Samsung Electronics

This guide is protected under international copyright laws.

No part of this guide may be reproduced, distributed, translated, or transmitted in any form or by any means, electronic or mechanical, including photocopying, recording, or storing in any information storage and retrieval system, without the prior written permission of Samsung Electronics.

- Please read this manual before using the device to ensure safe and proper use.
- The illustrations in this user manual may differ from the actual device. Device specifications are subject to change without prior notice and this document may not have been updated to reflect these changes.
- Bluetooth® is a registered trademark of Bluetooth SIG, Inc. worldwide.

Device layout

Front

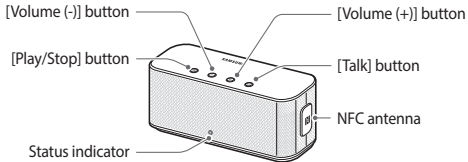

Back



- Check the product box for the wireless speaker, charger (USB power adapter, USB cable), 3.5 mm audio cable, and user manual. The items supplied with the device and available accessories may vary by region.
- The status indicator is visible only when it is turned on.

Charging the device

This device has a built-in battery. Charge the battery completely before using the device for the first time or after it has not been used for an extended period.

Connect the charger to the Bluetooth speaker and plug the power cord into the power outlet.



Use only the battery charger supplied with the product. Using unapproved chargers may slow down the charging process or cause damage to the product.



- The status indicator turns red while the device is being charged. The status indicator turns blue when charging is complete.



- To save energy, unplug the charger when not in use. The charger does not have a power switch, so you must unplug the charger from the electric socket when not in use to avoid wasting power. The device should remain close to the electric socket while charging.
- The socket-outlet shall be installed near the equipment and shall be easily accessible.

Charging time and standard run times (3,600 mAh)

Charging time	Approx. 2 hrs	
Standard run times	Call time	Approx. 15 hrs
	Play time	Approx. 15 hrs
	Standby time	Approx. 1,800 hrs



- Battery run time is based on results of tests performed with factory default settings.
- The battery charging time and run times may vary, depending on the usage environment.

Measuring the battery charge

Press and hold the [Talk] and [Volume (-)] buttons simultaneously. The status indicator flashes 5 times in different colours, according the charge left in the battery.

Charge level	Indicator colour
More than 80 %	Blue
30–80 %	Purple
Less than 30 %	Red

Turning the device on or off

Slide the [Power] switch to turn the device on or off. When you turn on the device for the first time, it enters the Bluetooth pairing mode.

- When the device is turned on, the status indicator flashes blue 4 times.
- When the device is turned off, the status indicator turns blue and then flashes red before turning off.

Setting the status indicator

When the device is turned on, the status indicator turns on or flashes in different colours, according to the status of the device. Press and hold the [Volume (+)] and [Volume (-)] buttons simultaneously to enable or disable the status indicator.

- When the power is turned on, the status indicator flashes blue periodically.

- The status indicator mode cannot be changed when the device is in the Bluetooth pairing mode.
- The status indicator mode for turning the device on or off, alerting you to calls, entering the Bluetooth pairing mode, and alerting you to a low battery level cannot be disabled.

Connecting to other devices

You can connect the wireless speaker to other Bluetooth-enabled devices, such as smartphones, tablets, or PCs. Also, if you have devices that support the near field communication (NFC) feature, you can control the Bluetooth feature to connect the devices to the wireless speaker.

When connecting for the first time, pair the wireless speaker with the other Bluetooth-enabled device. Keep the devices close to each other while pairing or using the wireless speaker.



Instructions for Bluetooth connection or Bluetooth connection via NFC may vary by device. Refer to the device's user manual for additional information.

Connecting via Bluetooth

- 1 Turn on the wireless speaker.
Press and hold the [Pairing (⌘)] button for about 3 second.
 - The wireless speaker enters the Bluetooth pairing mode and the status indicator turns on blue.
- 2 On the Bluetooth-enabled device, access the Bluetooth setup mode and search for Bluetooth devices.
- 3 From the search results, select the product name.
 - When pairing is complete, the wireless speaker appears as "Connected" in the device list.

Connecting via the NFC function

- 1 Enable the NFC feature on the other device.
- 2 Turn on the wireless speaker and bring the other device's NFC antenna close to the NFC antenna on the wireless speaker.

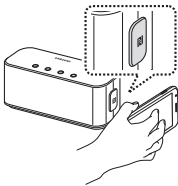

- If you are connecting a smartphone to the device, unlock the screen. The NFC feature may not work when the smartphone screen is locked.

3 Follow the on-screen directions to complete the connection.

Ending the Bluetooth connection

To disconnect the wireless speaker, turn it off or disable the Bluetooth functionality on the Bluetooth-enabled device.

You can also bring the NFC antennas together to end the Bluetooth connection between the devices.

Connecting via an audio cable

You can connect your smartphone or a media player to the wireless speaker with an audio cable.

End the Bluetooth connection between the product and any other device before making a connection with the audio cable.

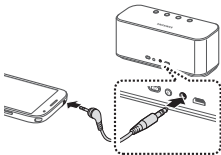

Using the wireless speaker

When the wireless speaker is connected to a Bluetooth or NFC-enabled device, you can play audio on the wireless speaker or use it as a speaker phone.

Playing audio

Play audio from your smartphone, multimedia player, or PC.

- Adjust the volume with the [Volume (+)]/(-)] buttons.
- A notification will sound when the speaker volume reaches its maximum value. If the sound is not loud enough even with the speaker volume set to maximum, adjust the volume of the connected device.

- Press the [Play/Stop] button to pause or resume playback.
- Press the [Play/Stop] button twice to skip to the next file.
- Press and hold the [Talk] button to turn the 3D SoundAlive feature on or off.



- Some device may allow you to control only the volume.
- The audio cable connection allows you to control only the volume.

Receiving a call

If a smartphone is connected to the wireless speaker, you can press the [Talk] button to answer a call.

- Press and hold the [Talk] button to reject a call.
- Press the [Talk] button to end a call.
- Press the [Volume (+)/(-)] buttons to adjust the volume.
- Press the [Play/Stop] button to mute or unmute the microphone.
- Press and hold the [Talk] button to pause or resume a call.

If an incoming call is detected during a call, the indicator flashes blue 2 times and the ringtone will sound.

- Press the [Talk] button to end the current call and answer the incoming call.
- Press and hold the [Talk] button to hold the current call and answer the incoming call.
- Press the [Talk] button to switch between calls.

Specifications and features

Dimensions (mm)	164.3 X 62.3 X 69.2
Weight	535 g
Transmission power	1 mW
Bluetooth frequency	2402–2480 MHz

Bluetooth version	BT 3.0
Supported Bluetooth profile	A2DP, HSP, HEP, AVRCP
Wireless connection range	10 m
NFC frequency	13.56 MHz

Operating temperature	-20 °C–60 °C
--------------------------	--------------



The wireless connection range may vary, depending on the usage environment.

Safety information

This safety information contains content for mobile devices. Some content may be not applicable to your device. To prevent injury to yourself and others or damage to your device, read the safety information about your device before using the device.

Do not touch the power cord with wet hands or disconnect the charger by pulling the cord

Use manufacturer-approved batteries, chargers, accessories, and supplies

Do not drop or cause an impact to the device

Do not store your device near or in heaters, microwaves, hot cooking equipment, or high pressure containers

Keep your device dry

Do not store your device in very hot or very cold areas. It is recommended to use your device at temperatures from -20 °C to 60 °C

Do not store your device near magnetic fields

Do not disassemble, modify, or repair your device

Any changes or modifications to your device can void your manufacturer's warranty. If your device needs servicing, take your device to a Samsung Service Centre.

When cleaning your device, mind the following

- Wipe your device or charger with a towel or an eraser.
- Do not use chemicals or detergents. Doing so may discolour or corrode the outside the device or may result in electric shock or fire.

Correct disposal of this product



(Waste Electrical & Electronic Equipment)

(Applicable in countries with separate collection systems)

This marking on the product, accessories or literature indicates that the product and its electronic accessories (e.g. charger, headset, USB cable) should not be disposed of with other household waste.

To prevent possible harm to the environment or human health from uncontrolled waste disposal, please separate these items from other types of waste and recycle them responsibly to promote the sustainable reuse of material resources.

Household users should contact either the retailer where they purchased this product, or their local government office, for details of where and how they can take these items for environmentally safe recycling.

Business users should contact their supplier and check the terms and conditions of the purchase contract. This product and its electronic accessories should not be mixed with other commercial wastes for disposal. This EEE is compliant with RoHS.

C € 0168

Declaration of Conformity

Product details

For the following

Product : Wireless Speaker

Model(s) : EO-SB330

Declaration & Applicable standards

We hereby declare, that the product above is in compliance with the essential requirements of the R&TTE Directive (1999/5/EC) by application of the standards below.

This product also meets the essential requirements and other relevant provisions of the EMC Directive (2004/108/EC) and the LVD Directive (2006/95/EC).

EN 60950-1:2006+A11:2009+A1:2010+A12:2011

EN 55013:2001/A2:2006

EN 55020:2007/A11:2011

EN 301 489-1 V1.9.2

EN 301 489-3 V1.4.1

EN 301 489-17 V2.2.1

EN 302 291-1 V1.1.1

EN 302 291-2 V1.1.1

EN 300 328 V1.8.1

EN 62479:2010

CE 0168

Representative in the EU

129, Samsung-ro, Yeongtong-gu,

Suwon-si, Gyeonggi-do

30 October 2013

(Place and date of issue)



Yang-Hoon Lim / Senior Engineer

(Name and signature of authorized person)

FCC Statement

This device complies with part 15 of the FCC Rules. Operation is subject to the following two conditions:

- (1) This device may not cause harmful interference, and**
- (2) this device must accept any interference received, including interference that may cause undesired operation.**

Users are not permitted to make changes or modify the device in any way.

Changes or modifications not expressly approved by Samsung will void the user's authority to operate the equipment.

Part 15.105 (B)

Note : This equipment has been tested and found to comply with the limits for a Class B digital device, pursuant to part 15 of the FCC Rules. These limits are designed to provide reasonable protection against harmful interference in a residential installation. This equipment generates, uses and can radiate radio frequency energy and, if not installed and used in accordance with the instructions, may cause harmful interference to radio communications. However, there is no guarantee that interference will not occur in a particular installation. If this equipment does cause harmful interference to radio or television reception, which can be determined by turning the equipment off and on, the user is encouraged to try to correct the interference by one or more of the following measures:

- Reorient or relocate the receiving antenna.**
- Increase the separation between the equipment and receiver.**
- Connect the equipment into an outlet on a circuit different from that to which the receiver is connected.**
- Consult the dealer or an experienced radio/TV technician for help.**

Modifications not expressly approved by the manufacturer could void your authority to operate the equipment under FCC rules.

IC Statement

This device complies with Industry Canada licence-exempt RSS standard(s).

Operation is subject to the following two conditions: (1) this device may not cause interference, and (2) this device must accept any interference, including interference that may cause undesired operation of the device.

Cet appareil est conforme avec Industrie Canada RSS standard exempts de licence (s).

Son fonctionnement est soumis aux deux conditions suivantes :

- (1) cet appareil ne peut pas provoquer d'interférences et**
- (2) cet appareil doit accepter toute interférence, y compris les interférences qui peuvent causer un mauvais fonctionnement du dispositif.**